

VIGILANT II MODELS # 0035 & 0036

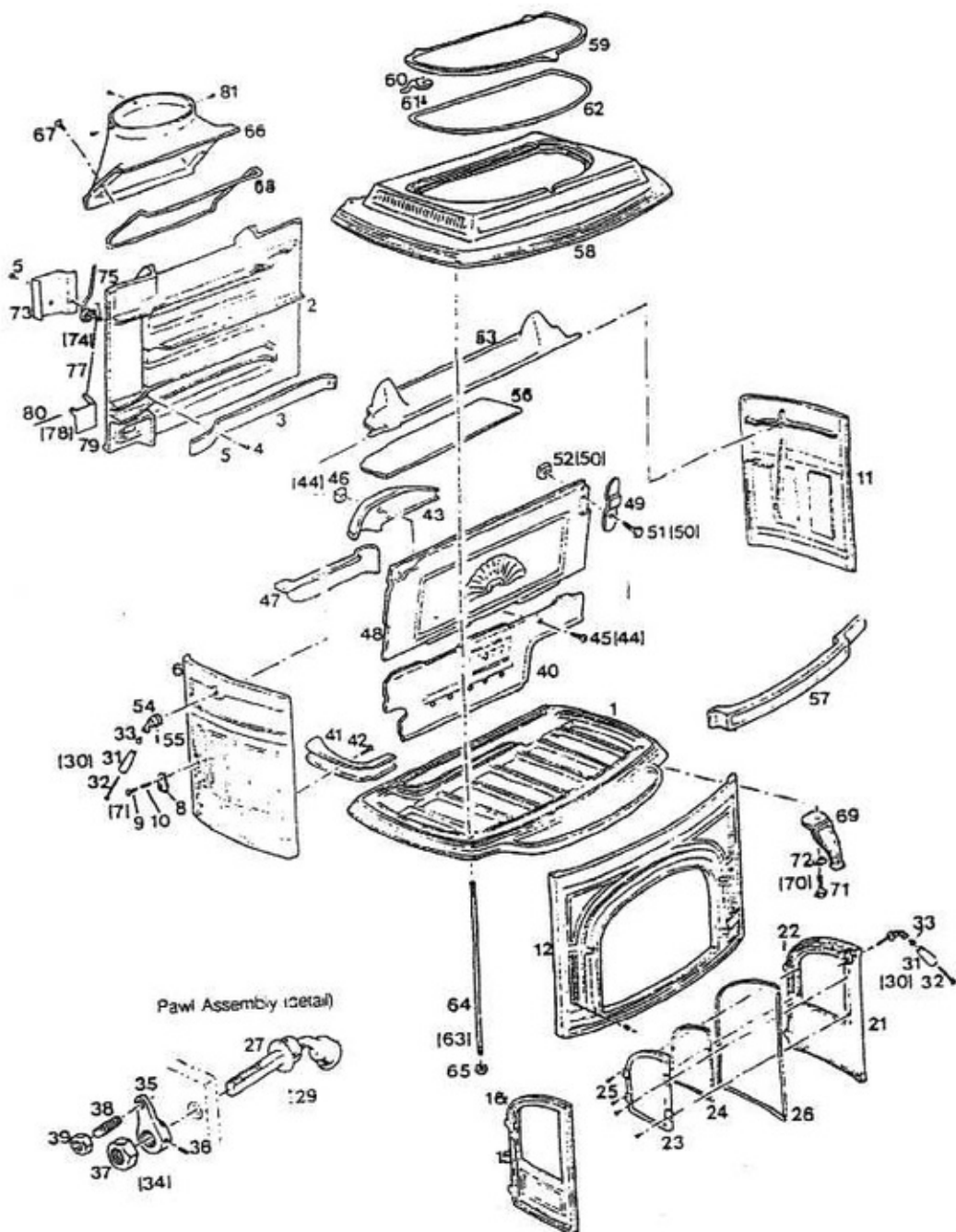

VIGILANT

MODEL 0035 & 0036 VIGILANT II

FEATURES: MANUFACTURED THROUGH
WRAP AROUND FRONT TWO PIECE
SOME MODELS HAVE WITH CAST FRAMES
SOME HAVE DOUBLE GLASS WITH STAINLESS FRAMES
SOME HAVE DOUBLE GLASS WITH CLIPS- NO FRAMES

DIAGRAM

#	ITEM #	PART DESCRIPTION
1	130-4258	BOTTOM
2	130-4277	BACK
3	130-0787	NIGHT AIR COVER
4	120-0889	NIGHT AIR COVER SCREW
5	1304371	CLEAN GLASS PRIM. AIR TUBE (USED DOUBLE GLASS STOVES)
5	120-0998	(10 24 X PH TR SCREW)
6	130-4269	LEFT END
8	130-0671	SECONDARY AIR COVER
9	120-I 007	I-24 X TRS HD PH
	120-I 846	THERMOSTAT TENSION SPRING
11	130-4262	RIGHT END
12	130-4273	FRONT ONLY
13	500-0945	FRONT AND DOORS ASSEMBLED (DOES NOT INCLUDE GLASS)
15	130-4224	LEFT DOOR
16	160-0546	DOOR PIN
17	130-4231	LEFT DOOR CAST INSERT
18	120-3560	3 NEEDLE. FIBERGLASS/PER FT.
19	120-0998	HEAT SHIELD HOLE SCREW
21		RIGHT DOOR
22	160-0546	DOOR PIN
23	130-4238	RIGHT DOOR CAST INSERT
24	120-3560	3 NEEDLE. FIBERGLASS/PER FT.
25	120-0998	HEAT SHIELD HOLE SCREW
27	0004370	FRONT HANDLE STUB
30	000-4342	CERAMIC HANDLE SCREW
31	160-0620	CERAMIC SHAFT ONLY
32	120-I 364	HANDLE PIN (LONG 3
	120-1294	HANDLE PIN (SHORT 3
33	160-0650	NUB FOR CERAMIC HANDLE
34	000-4384	PAWL ASSEMBLY

36	120-0417	SET SCREW
37	120-3290	LARGE PAWL NUT
38	120-0436	STRIKER BOLT
39	120-3210	STRIKER BOLT NUT
40	130-4135	LOWER
41	130-0872	PRIMARY
42	120-0830	X 1 PH FL HD
43	130-0829	COVER PLATE B (AIRHORN)
44	120-3329	NUT 20 SQ NUT)
	120-0889	NIGHT AIR COVER SCREW
45	120-0848	
46	120-3329	NUT 20 SQ NUT)
47	130-0821	COVER PLATE A (BEHIND FB)
48	130-4120	UPPER
49	130-4148	DAMPER RETAINER
51	120-I 374	20 X HEX HD CAP
52		DAMPER RETAINER NUT 20 SQ.)
53	500-0992	DAMPER WELDED PIN)
54		DAMPER HANDLE STUB
	120-0563	DAMPER HANDLE SET SCREW
55	120-0417	SET SCREW
56	130-0876	SMOKE SHELF
57	500-2829	ASH FETTLE COMPLETE
		(USED DOUBLE GLASS STOVES)
	130-4366	ASH FETTLE BACK ONLY
	130-4362	ASH FETTLE FRONT ONLY
	130-4023	ASH FETTLE (SINGLE GLASS MODEL)
58	130-4251	TOP
59	130-0797	GRIDDLE ALONE
60	000-4444	GRIDDLE QUADRANT
61	120-I 338	HEX HD CAP
62	120-3668	PER FT.
63	500-7498	TIE ROD SET
65		TIE ROD NUT
66	130-4280	FLUE COLLAR
67	120-0907	1 PH RD HD
68	120-3560	3 NEEDLE. FIBERGLASS/PER FT.
69	130-3225	LEG (1 ONLY)
	500-0360	LEGS (SET OF 4)
70	000-5808	LEG BOLTS SET
73	160-1487	THERM COVER
75	0004320	THERMOSTAT
76	120-1846	THERMOSTAT TENSION SPRING
77	120-I 960	THERMOSTAT BALL CHAIN (PER FT)
79	000-5800	THERM FLAP WITH EYELET
80	160-1555	THERM FLAP PIN
	120-0998	HEAT SHIELD HOLE SCREW