



# SDDVT Series Stardance® Direct Vent Gas Heater Installation and Operating Instructions

Models: SDDVT(CS)CBSB, SDDVT(CS)BSSB, SDDVT(CS)BDSB, SDDVT(CS)BMSB

**▲ WARNING:**

**FIRE OR EXPLOSION HAZARD**

Failure to follow safety warnings exactly could result in serious injury, death or property damage.

- Do not store or use gasoline or other flammable vapors and liquids in the vicinity of this or any other appliance.
- **WHAT TO DO IF YOU SMELL GAS**
  - Do not try to light any appliance.
  - Do not touch any electrical switch; do not use any phone in your building.
  - Leave the building immediately.
  - Immediately call your gas supplier from a neighbor's phone. Follow the gas supplier's instructions.
  - If you cannot reach your gas supplier, call the fire department.
- Installation and service must be performed by a qualified installer, service agency or the gas supplier.

**WARNING:** Improper installation, adjustment, alteration, service or maintenance can cause injury or property damage. Refer to this manual. For assistance or additional information consult a qualified installer, service agency or the gas supplier.

This appliance may be installed in an aftermarket,\* permanently located, manufactured home (USA only) or mobile home, where not prohibited by local codes.

This appliance is for use only with the type of gas indicated on the rating plate. This appliance is not convertible for use with other gases, unless a certified kit is used.

\* Aftermarket: Completion of sale, not for purpose of resale, from the manufacturer.

**CERTIFIED  
SAFETY BARRIER**



## DANGER

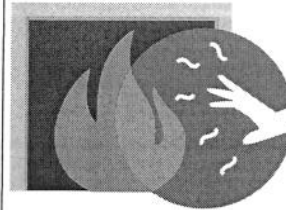

**HOT GLASS WILL  
CAUSE BURNS.**

**DO NOT TOUCH GLASS  
UNTIL COOLED.**

**NEVER ALLOW CHILDREN  
TO TOUCH GLASS.**

A barrier designed to reduce the risk of burns from the hot viewing glass is provided with this appliance and shall be installed.

**INSTALLER:** Leave this manual with the appliance.  
**CONSUMER:** Retain this manual for future reference.

### Replacement Parts

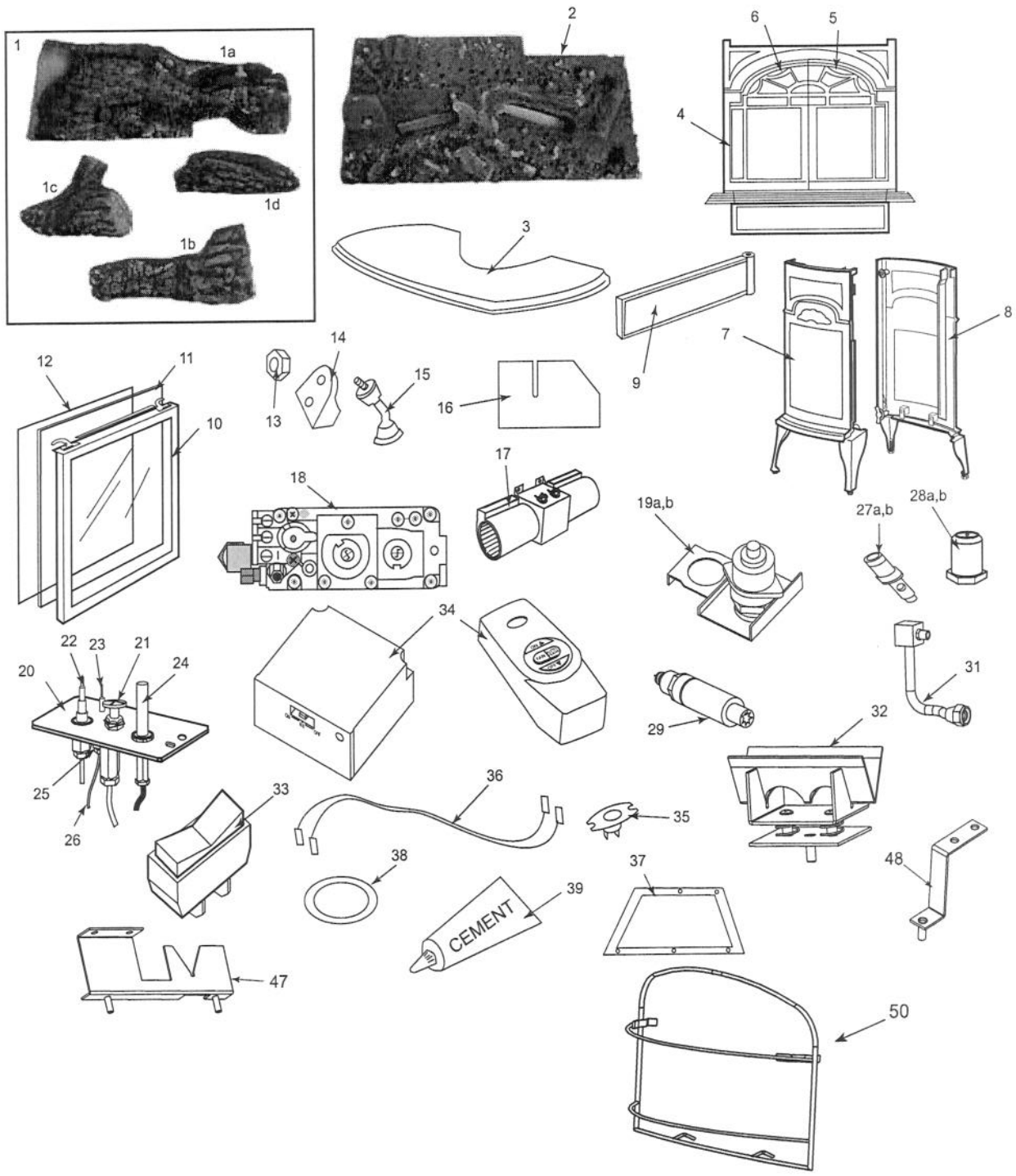

Vermont Castings Group reserves the right to make changes in design, materials, specifications, prices and discontinue colors and products at any time, without notice.

## Replacement Parts

Ref.	Description	SDDVT/SDDVTCS
1.	Log Set - Complete	20012551
1a.	Log Rear	20012546
1b.	Log Right	20012548
1c.	Log Left	20012547
1d.	Log Top	20012915
2.	Ember Bed Assembly	20012492
3.	Top	Refer to Enamel Parts Chart
4.	Front, Operable Door	Refer to Enamel Parts Chart
5.	Door Right	Refer to Enamel Parts Chart
6.	Door Left	Refer to Enamel Parts Chart
7.	Left End	Refer to Enamel Parts Chart
8.	Right End	Refer to Enamel Parts Chart
9.	Door, Control	1301087
10.	Glass Frame Assembly	30000127
11.	Glass	1601691
12.	Gasket, Glass - Med. Knit	1203702
13.	Nut, Hex Jam 3/8-16 TOPLK-Z	1203290
14.	Pawl Assy, Ash Door	5004025
15.	Front Steel Handle/Shaft - NI/VER	30002717
16.	Restrictor Plate	20013026
17.	Fan Blower (SDDVTCS Series Only)	30005069
18.	Valve Nova SIT820.852 RN	20012218
18a.	Valve SIT MV HI/LO 0.820.652 - Nat. (SDDVTCS Series only)	37D0117
19a.	Stepper Motor - SIT820 - Nat. (SDDVTCS Series only)	50D0099
19b.	Stepper Motor - SIT820 - LP (SDDVTCS Series only)	50D0100
20a.	Pilot Assembly 3Way N/DV RN 0.199.706	10002264
20b.	Pilot Assembly 3Way N/DV RP 0.199.703	10002265
21.	Pilot Top Convertible	10002266
22.	Thermocouple 24"	7531137
23.	Electrode Ignitor w/Cable SIT24	10001297
24.	Thermopile 18" RS	7533113
25.	Nut Electrode SIT #0.974.144	57886
26.	Tubing Pilot w/Fittings 1/8 x 24"	10001296
27a.	Pilot Orifice #62 - NG Top Convertible	37D0022
27b.	Pilot Orifice #35 - LP Top Convertible	37D0023
28a.	Orifice Hood #53 (.0595") LP	20007347
28b.	Orifice Hood #38 (0.101") Nat.	20009310
29.	Ignitor Piezo w/Nut SIT	057958
30.	Bracket Piezo Ignitor/Control (not shown) (SDDVTCS Series only)	20300111
31.	Manifold Assembly	20012553
32.	Air Shutter Assembly	20012517
33.	Trim ON/OFF Switch	30000874

## Replacement Parts

Ref.	Description	SDDVT/SDDVTCS
34.	Remote Kit (Hi/Lo, Blower) (SDDVTCS Series only)	RCSITEA
35.	Sensor 1450 CMG-8184-0032 (for use with FSDHAG only)	10002013
36.	Wiring Harness	10002582
37.	Gasket, Base Pan	20002282
38.	Gasket HE Door	1203687
39.	Gasket Cement	1206122
40.	Handle Package, Ceramic w/Screw (not shown)	0004345
42.	Switch Bracket (not shown)	53821
43.	Starter Pipe (not shown)	30000245
44.	Rear Shroud (not shown)	20003802
45.	1/4" Fiberglass Gasket (not shown)	1203560
46.	*Magnet, Door (not shown)	30004112
47.	Right Burner Support Assembly	20012512
48.	Tie Bracket Assembly	20012514
49.	Rear Shroud Assy. (SDDVTCS Series Only) (not shown)	20300122
50.	Safety Screen Barrier	30007254

\*Use common super glue or silicone to attach magnets.

## Fuel Conversion Kits

Description	SDDVT SERIES	SDDVTCS SERIES
Conversion Kit, NG to LP	20012735	20300126
Conversion Kit, LP to NG	20012903	20300127

## Shell Enamel Parts

Color	Top	Left End	Right End	Front OP	Left Door*	Right Door*	Left Door**	Right Door**
Classic Black	30001276	30001280	30001279	30001496	30001139	30001138	30004082	30004081
Biscuit	30003305	30003300	30003301	30003302	30003304	30003303	30004090	30004089
Bordeaux	30006752	30006750	30006751	30006753	n/a	n/a	30006755	30006754
Brown Majolica	30004897	30004895	30004896	30004899	n/a	n/a	30004900	30004901
Ebony Black	30001304	30001308	30001307	30001270	30001272	30001271	30004086	30004085

\* These doors have a front handle.

\*\* These doors do not have a handle, they are closed with a magnet.